

ARTICOLI INDUSTRIALI STAMPATI

in gomma _ silicone _ pvc _ polietilene

> PASSACAPO

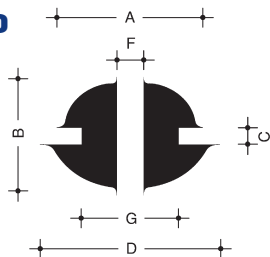

Articolo	A mm.	B mm.	C mm.	D mm.	F mm.	G mm.
31.01.175	36	22	3,2	42	18/21	30
31.01.176	31	19	3,2	36	9/11	25
31.01.177	24	22	3,2	40	9/11	25
31.01.178	22	17	3,0	26	6/16	15

> SOFFIETTI E TUBI CORRUGATI

Proteggono le parti mobili dei macchinari dalla polvere e da altre sostanze, consentendo il più ampio movimento in estensione e in contrazione.

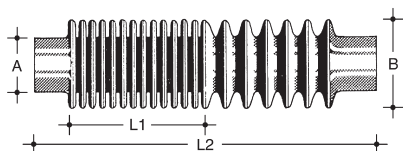

Articolo	A mm.	B mm.	L1 mm.	L2 mm.	Numero spire
38.03.005	30	45	25	150	12
38.03.011	85	109	50	210	9
38.03.021	140	200	50	400	10
38.03.022	20	45	30	75	8
38.03.023	45	100	35	140	4
38.03.024	20	54	35	75	8
38.03.025	20	54	35	75	8
38.03.026	70	100	70	120	11
38.03.027	30	75	45	180	8
38.03.028	70	110	90	350	12

> PIPETTE

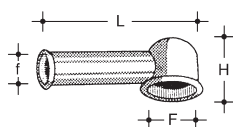

Articolo	H mm.	f mm.	F mm.	L mm.
34.03.236	12	7	12	40
34.03.237	16	7	15	41
34.03.243	25	8	15	40
34.03.244	8	1,5	9	31

> CUFFIETTE

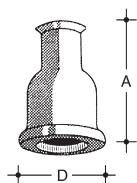

Articolo	D mm.	A mm.
33.01.166	15	25
33.01.167	23	24
33.01.068	13	25

> BOCCOLE

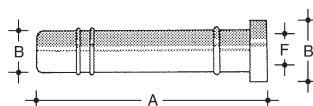

Articolo	F mm.	B mm.	D mm.	A mm.
34.21.230	4	7	10	25
34.21.231	6,5	9	14	40
34.21.236	7,5	7,5	16	40
34.21.232	8	10	13	51
34.21.233	8	11	14	33
34.21.234	10	11	17	43
34.21.235	10	10	18	73
34.21.237	3,5x6	9	8x11	25

> CAPPuccio

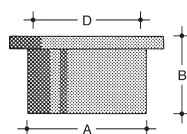

Articolo	B mm.	D mm.	A mm.
34.01.169	13	18	20

> VENTOSE CON PALLINA

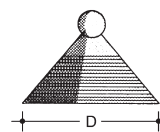

Articolo	D mm.
35.21.100	20
35.21.101	25
35.21.102	30

> VENTOSE CON BOTTONE

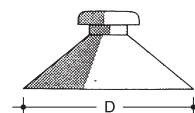

Articolo	D mm.
35.01.106	35
35.01.107	38
35.01.108 con vite da 5 m/a	38

> VENTOSE CON CILINDRETTO

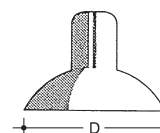

Articolo	D mm.
35.21.111	14
35.21.112	20
35.21.113	23
35.21.114	29

> VENTOSA ASPIRAFOGLI

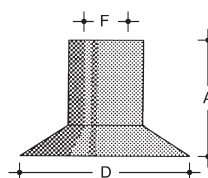

Articolo	A mm.	D mm.	F mm.
35.11.001	17	25	5
35.01.002	15	25	5
35.01.110	15	17	12
35.01.111	27	27	10
35.01.112	38	30	10
35.01.113	30	43	12
35.01.114	27	35	10

> VENTOSA CON ANELLO

Particolarmente indicata per il sollevamento di pannelli di grandi dimensioni, di qualsiasi materiale con superficie liscia (es.: vetro, lamiera, plastica)

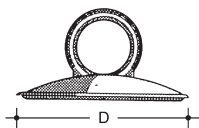

Articolo	D mm.
35.01.099	100

> MANOPOLA PER CARRIOLA

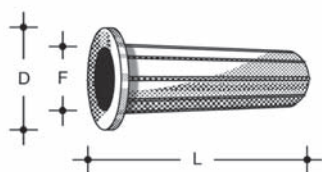

Articolo	L mm.	F mm.	D mm.
35.21.103	107	25	41

> ANELLI TIPO O-RING

Vasto assortimento di anelli in gomma sintetica, viton, silicone nelle misure internazionali.

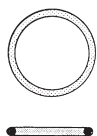

> ANELLI STAMPATI A SEZIONE RETTANGOLARE

Su richiesta si realizzano ranelle di ogni tipo e misura.

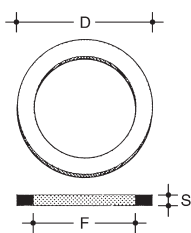

Articolo	F mm.	D mm.	S mm.
33.01.184	25	35	3
33.01.185	30	40	3
33.01.186	35	45	3
33.01.187	37	51	3
33.01.188	40	50	3
33.01.189	44	65	3
33.01.191	50	63	3
33.01.193	55	68	3
33.01.196	60	73	3
33.01.197	62	80	3
33.01.199	65	78	3
33.01.200	68	82	3
33.01.202	75	89	3

> ANELLI STAMPATI A SEZIONE TONDA

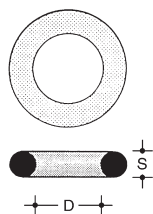

Articolo	S mm.	D mm.
----------	-------	-------

In gomma

35.01.258	5	10
35.01.261	5	13
35.01.263	6	14
35.01.266	6	16
35.01.267	6	17
35.01.268	7	19
35.01.270	7	20
35.01.271	7	21
35.01.272	7	22
35.01.273	7	23
35.01.278	7	27

In para

35.11.255	4	8
35.11.266	4	16
35.11.267	1,5	18
35.11.276	5	25
35.11.278	6,36	25,7
35.11.279	4	30
35.11.280	7	30
35.11.281	10	30
35.11.282	11	30
35.11.283	7,5	37
35.11.293 c/cav est.	6	56
35.11.294 c/cav int.	6	56
35.11.295	5	95
35.11.296	7,6	62
35.11.297	5	70
35.11.298	7,6	77
35.11.299	7,6	93
35.11.300	6	140
35.11.301	3	154

> RONDELLE TRANCIATE A SEZIONE RETTANGOLARE

Tutte le misure su richiesta. Si realizzano anche piccole quantità.

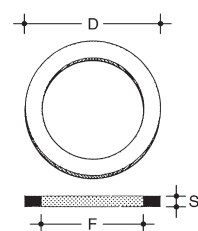

> VALVOLE SFERICHE

In gomma nera con nucleo di ghisa interno (sotto i 30 mm. senza nucleo). Particolarmente indicate come valvole di tenuta in pompe di aspirazione o di mandata, per ogni tipo di fluido.

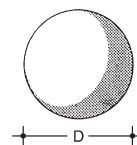

Articolo	D mm.
----------	-------

Solo gomma

33.01.203	12
33.01.204	14
33.01.205	15
33.01.206	16
33.01.207	18
33.01.208	20
33.01.209	22
33.01.210	25
33.01.211	28

Nucleo in ghisa o ferro

33.05.212	30
33.05.213	35
33.05.214	40
33.05.215	45
33.05.216	50
33.05.217	55
33.05.218	60
33.05.219	70
33.05.220	75
33.05.221	80
33.05.222	85
33.05.223	90
33.05.224	95
33.05.225	100

> PIEDINI REGOLABILI CROMATI

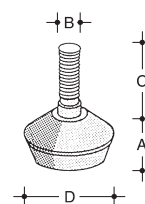

Articolo	D mm.	B mm.	C mm.	A mm.
26.35.001	20	6	13	7
26.35.002	25	8	20	10
26.35.003	30	8	20	11,5
26.35.004	35	8	20	12
26.35.005	40	8	25	13,5
26.35.006	25	10	20	10
26.35.007	30	10	20	11,5
26.35.008	35	10	20	12
26.35.009	40	10	25	13,5
26.35.010	50	10	30	15,5