

Articolo	B mm.	D mm.	A mm.
30.21.022	4,5	7,5	5,5

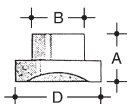

Articolo	B mm.	D mm.	A mm.
30.21.084	15	25	10
30.21.085	12	19,5	11
30.21.086	12	19,5	16

> PARACOLPI A VITE

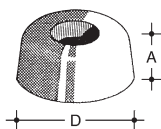

Articolo	D mm.	A mm.
30.21.029	11	7,5
30.21.030	13	6
30.21.031	16	9
30.21.032	18	8
30.21.033	18	10
30.21.034	20	10
30.21.035	19	10
30.21.036	19	13
30.21.038	21,5	11
30.21.039	22	10
30.21.040	26	10
30.21.041	25	11
30.21.043	30	9
30.21.044	31	14/18

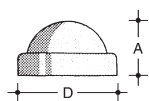

Articolo	D mm.	A mm.
30.01.023	23	13

> PUNTALI OVALI calzanti interni

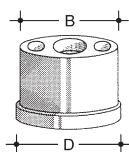

Articolo	B mm.	D mm.
32.21.099	37,5	17,5

> PUNTALI CILINDRICI calzanti interni

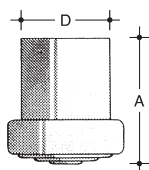

Articolo	D mm.	A mm.
32.01.047	10	16
32.01.049	12	27
32.21.050	13	23
32.01.051	14	26
32.01.053	16	26,5
32.01.054	18	28
32.01.055	18	27,7
32.01.056	19	26,6
32.01.057	20	26,5
32.01.059	21	28,5
32.21.061	22	32
32.01.062	23	32
32.01.063	24	33
32.01.064	25	27
32.01.065	26	28,5
32.01.066	28	29
32.01.067	30	28,5

> PUNTALI A PINZA

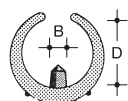

Articolo	D mm.	B mm.
31.21.200	14-16	5,5
31.21.201	16-18	5,5
31.21.202	18-20	5,5
31.21.203	20-22	5,5
31.21.204	22-24	5,5
31.21.205	24-26	5,5
31.21.206	28-30	5,5

> PUNTALI ANGOLARI calzanti esterni

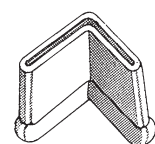

Articolo	mm.
30.21.118	25x25
30.21.119	30x30
30.21.120	35x35

> PUNTALI RETTANGOLARI calzanti interni

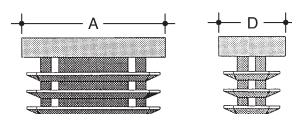

Articolo	D mm.	A mm.
28.27.101	10	15
28.27.102	10	20
28.27.103	10	25
28.27.104	10	30
28.27.105	10	40
28.27.106	15	20
28.27.107	15	25
28.27.108	15	30
28.27.110	15	35
28.27.111	15	40
28.27.112	15	50
28.27.113	20	25
28.27.114	20	30
28.27.115	20	40
28.27.116	20	50
28.27.117	25	40
28.27.118	25	50
28.27.119	30	40
28.27.120	30	50
28.27.121	40	80

> PUNTALI A PERA calzanti esterni



Articolo	D mm.
32.01.150	15
32.01.151	18
32.01.152	20
32.01.153	25
32.01.154	30
32.01.155	32

> PUNTALI IN PVC calzanti esterni



Articolo	A mm.	B mm.	C mm.	Ø mm.
32.21.156	49	34	45	32
32.21.157	60	42	58	40
32.21.158	60	42	58	35
32.21.159	64	52	61	45

ARTICOLI INDUSTRIALI STAMPATI

in gomma _ silicone _ pvc _ polietilene

> PUNTALI QUADRI calzanti interni

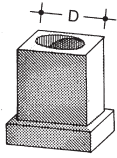

Articolo	D mm.
32.21.068	12
32.21.069	13
32.21.070	14
32.21.071	15
32.21.072	16
32.21.073	17
32.21.074	18
32.21.075	19
32.21.076	20
32.21.077	21
32.21.078	22
32.21.079	25
32.21.080	30
32.21.081	35
32.21.082	40

> PUNTALI calzanti esterni

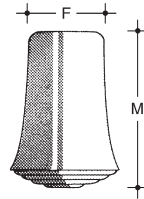

Articolo	F mm.	M mm.
32.21.117	6	17,5
32.21.102	8	26
32.21.103	10	30
32.21.104	12	30
32.01.105	12	30
32.01.106	14	30
32.01.107	16	36
32.01.108	18	38
32.01.109	20	40
32.01.110	22	40
32.01.111	24	40
32.01.112	26	40
32.01.113	28	40
32.01.114	30	40
32.01.115	32	40

> COPRITESTA CILINDRICO calzante interno

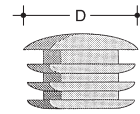

Articolo	D mm.
28.27.050	10
28.27.051	12
28.27.052	15
28.27.053	18
28.27.054	20
28.27.055	22
28.27.056	25
28.27.057	28
28.27.058	30
28.27.059	32
28.27.060	35
28.27.061	40
28.27.062	45
28.27.063	50
28.27.064	60
28.27.065	80

> PUNTALI QUADRI ALETTATI calzanti interni

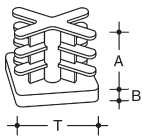

Articolo	T mm.	A mm.	B mm.
28.27.212	12x12	12	5
28.27.215	15x15	11	4
28.27.216	16x16	17	5
28.27.218	18x18	12	5
28.27.220	20x20	17	5
28.27.222	22x22	17	5
28.27.225	25x25	20	6
28.27.230	30x30	21	6
28.27.235	35x35	21	6
28.27.240	40x40	21	6
28.27.250	50x50	21	6
28.27.260	60x60	22	6
28.27.270	70x70	25	6
28.27.280	80x80	30	6

> PUNTALI A BASE TONDA calzanti esterni

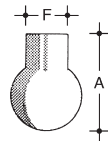

Articolo	F mm.	A mm.
30.21.121	3	13

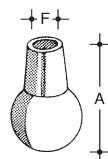

Articolo	F mm.	A mm.
30.21.122	5	22
30.21.123	6	22

> FERMAPORTE

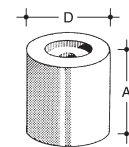

Articolo	D mm.	A mm.
34.21.163	20	23
32.21.164	18,5	18

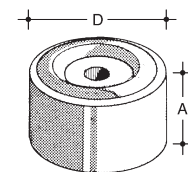

Articolo	D mm.	A mm.
34.01.165	40	25

> PUNTALI MICRO calzanti esterni

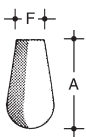

Articolo	F mm.	A mm.
30.21.124	3	12,5
30.21.125	5	12,5

> CILINDRETTO calzante esterno

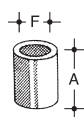

Articolo	F mm.	M mm.
30.21.126	5	8
30.21.127	4	9
30.21.128	2	5

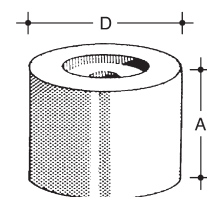

Articolo	D mm.	A mm.
34.01.166	30	30
34.01.167	37,5	30
34.01.168	30	25
34.01.169	25	24